

These drawings and specifications are the property of H2W Technologies, Inc. They are issued in confidence and shall not be reproduced, copied, or used without written permission from H2W Technologies, Inc.

REVISION TABLE							
REV	ECN#	DESCRIPTION			REV BY	APPROVED	DATE
---	---	Original Drawing			OOG	MPW	6-26-13
A	1702	Added Customer Payload Assembly			OOG	MPW	9-20-13

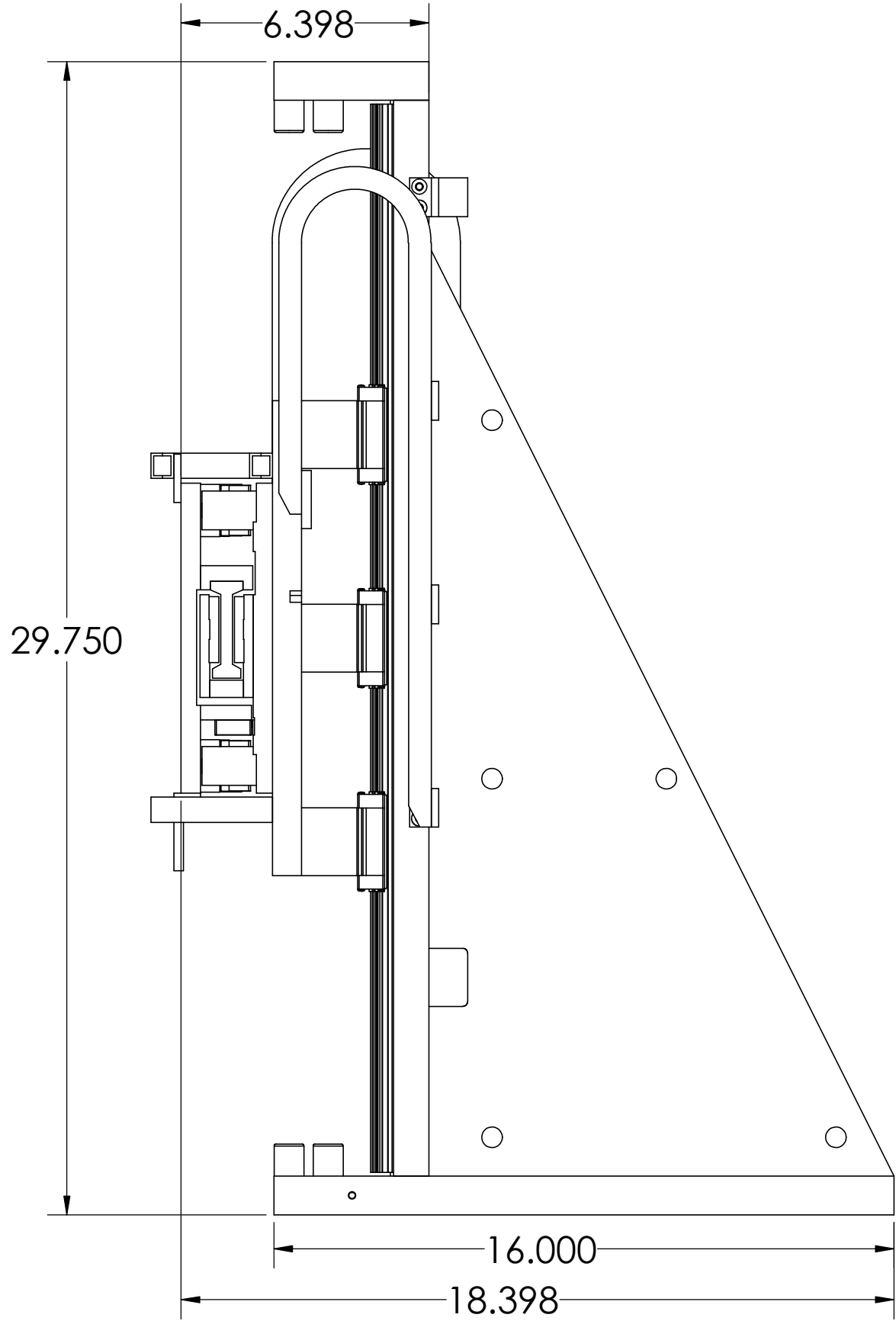
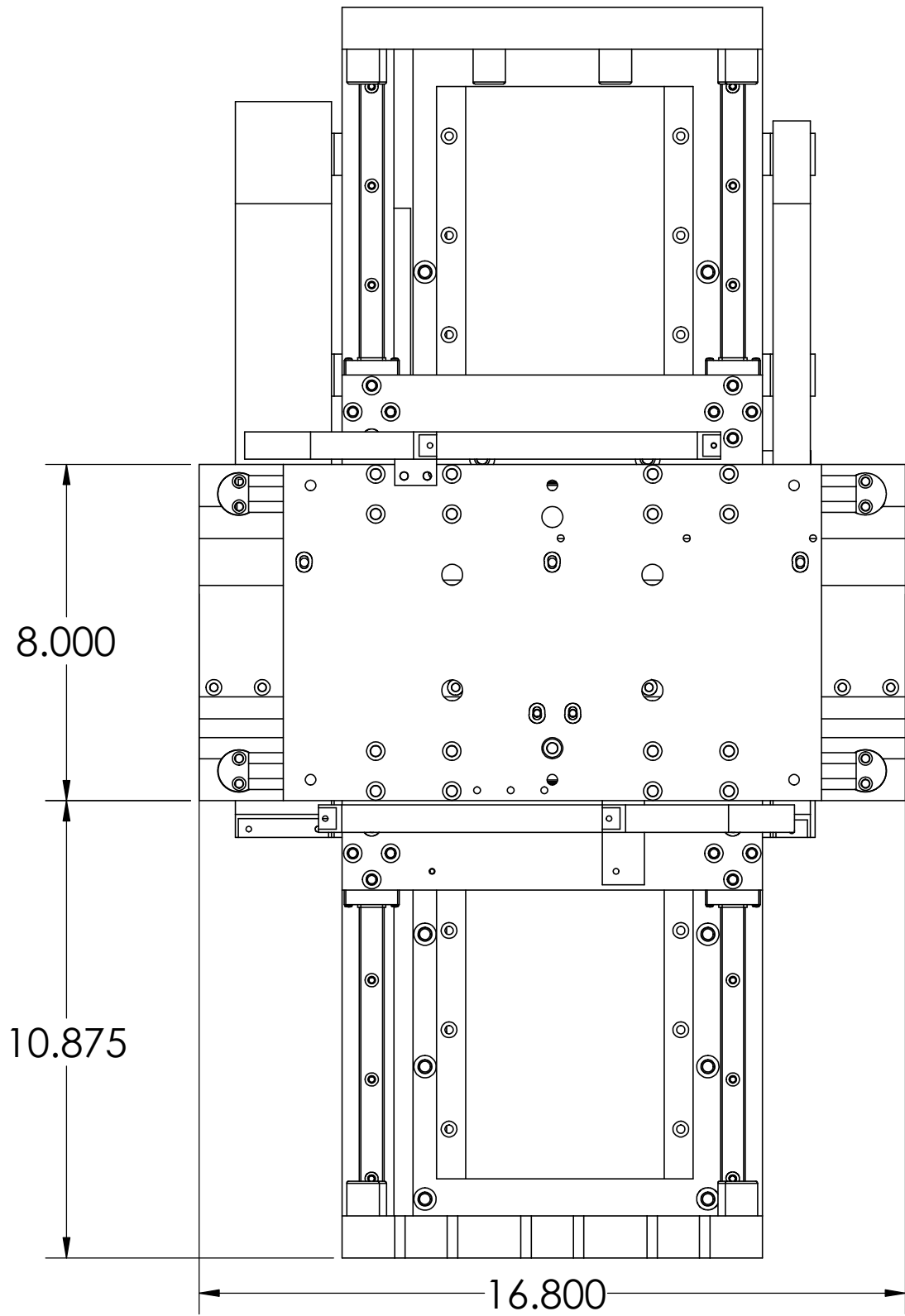
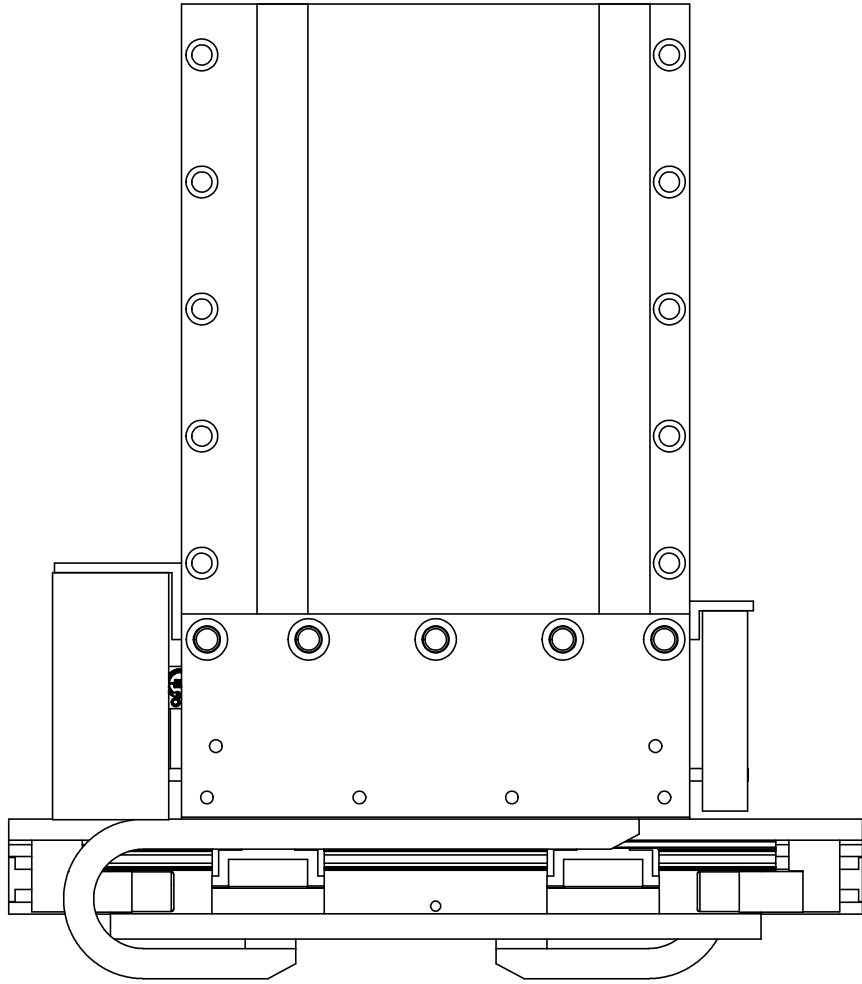

ALL AXIS SHOWN AT MID-STROKE

UNLESS SPECIFIED OTHERWISE: All dimensions are in inches. Standard Tolerances are as follows: XXX ±.005 ANGLES ±1° XX ±.010 FILLETS AND X ±.020 CORNERS .010 Remove All Burs and Sharp Edges				MATERIAL Aluminum 6061-T6		FINISH Anodize Blue		TITLE XZ Brushless Linear Motor Gantry	
				DRAWN OOG	DATE 6-26-13	APPROVED MPW	DATE 6-26-13	DWG # 47-0041	REV A
								SHEET 1 of 3	

H2W Technologies, Inc.
26470 Ruether Ave #102 Santa Clarita, CA 91350 USA
Tel: (661) 251-2081 Fax: (661) 251-2067
www.h2wtech.com

Stage Mounting Holes

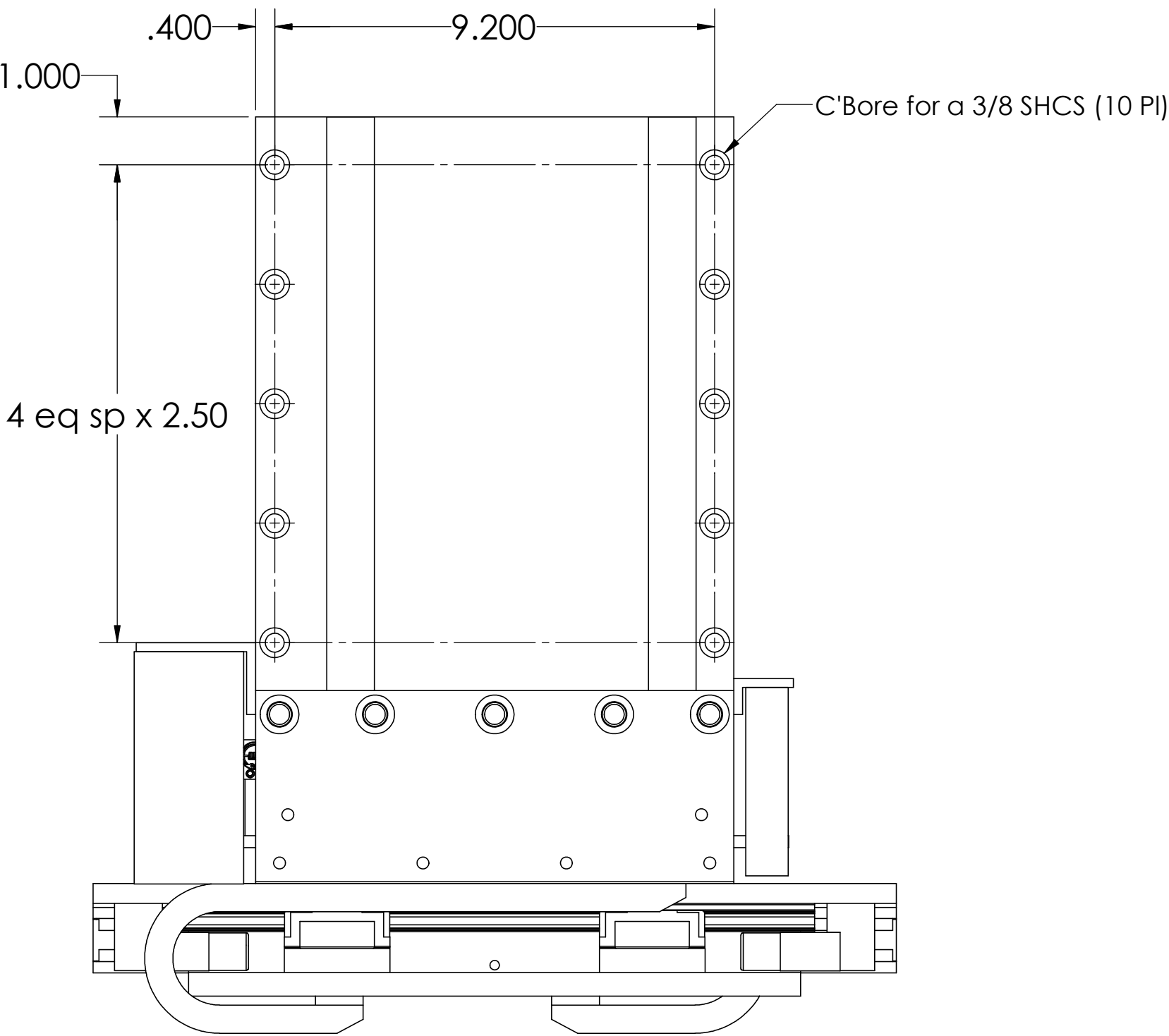

Payload Mounting Holes

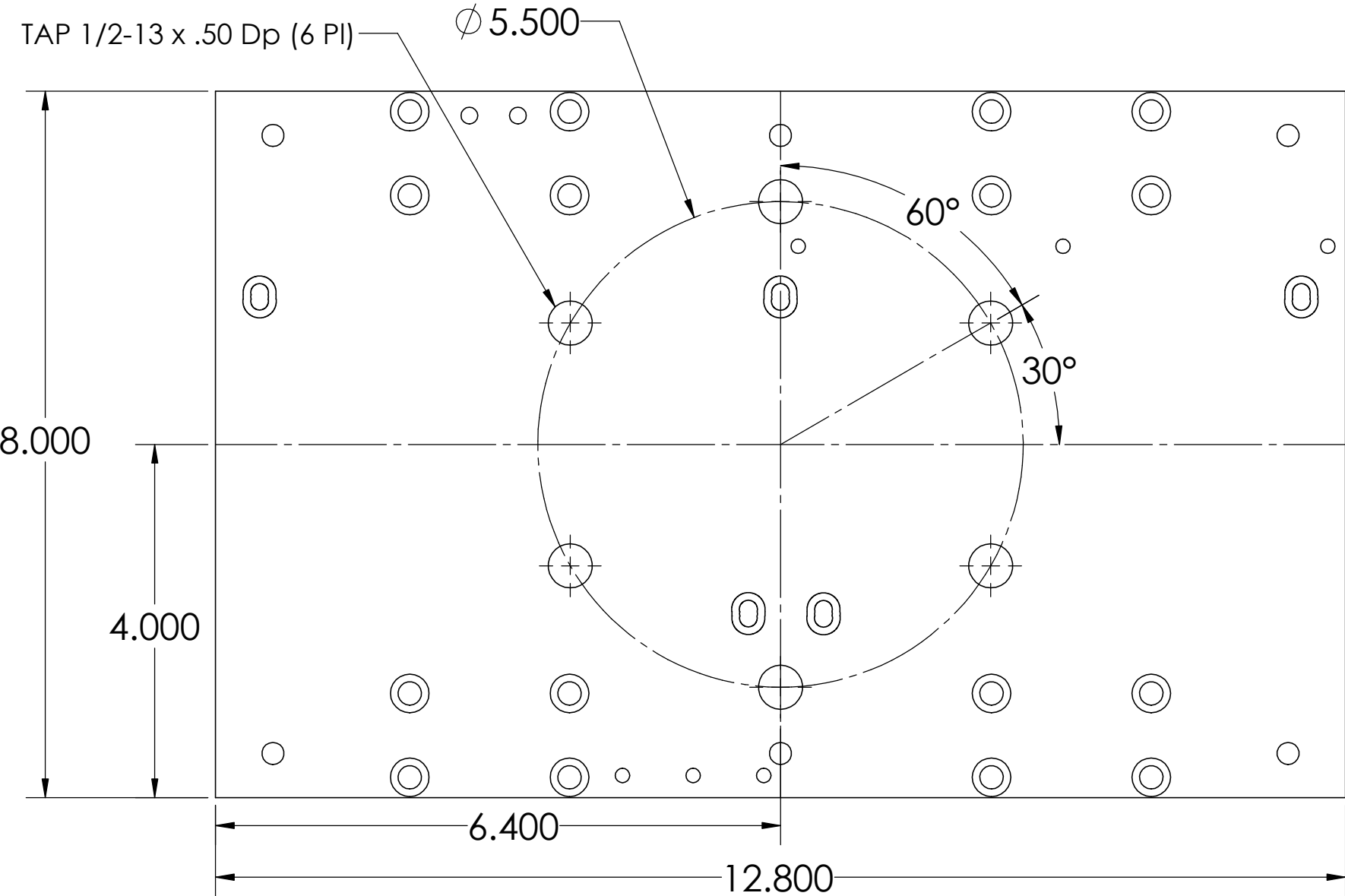

Horizontal X-Axis		
Motor P/N	BLDC-05	
Stroke	4.0 IN	101.6 mm
Encoder Resolution	1 micron	
Bearing Type	Recirculating Ball Bearing	
Moving Mass	12 lb	5.5 Kg
Total Mass	33 lb	15 Kg
Resistance @ 20C	20.2 ohms	
Inductance @ 20C	15.0 mH	
Electrical Time Constant	0.7 msec	
Motor Constant	3.36 LBS/SQRT(Watt)	14.95 N/SQRT(Watt)
Force Constant	15.3 LBS/Amp	68.1 N/Amp
Back EMF	2.0 V/ips	78.7 V/m/sec
Continuous Force	50.0 LBS	222 N
Max Power @ 100% Duty	215 Watt	
Peak Force	150 LBS	666 N
Max Power @ 10% Duty	1935 Watts	

Vertical Z-Axis		
Motor P/N	BLSRC-1	
Stroke	13.8 IN	350.5 mm
Encoder Resolution	1 micron	
Bearing Type	Recirculating Ball Bearing	
Moving Mass	21 LBS	9.5 Kg
Total Mass	95 LBS	43 Kg
Resistance @ 20C	6.1 ohms	
Inductance @ 20C	29.0 mH	
Electrical Time Constant	4.8 msec	
Motor Constant	8.89 LBS/SQRT(Watt)	39.6 N/SQRT(Watt)
Force Constant	21.5 LBS/Amp	95.5 N/Amp
Back EMF	2.80 V/ips	110.2 V/m/sec
Continuous Force	167	743 N
Max Power @ 100% Duty	353 Watt	
Peak Force	501 LBS	2224 N
Max Power @ 10% Duty	3177 Watts	

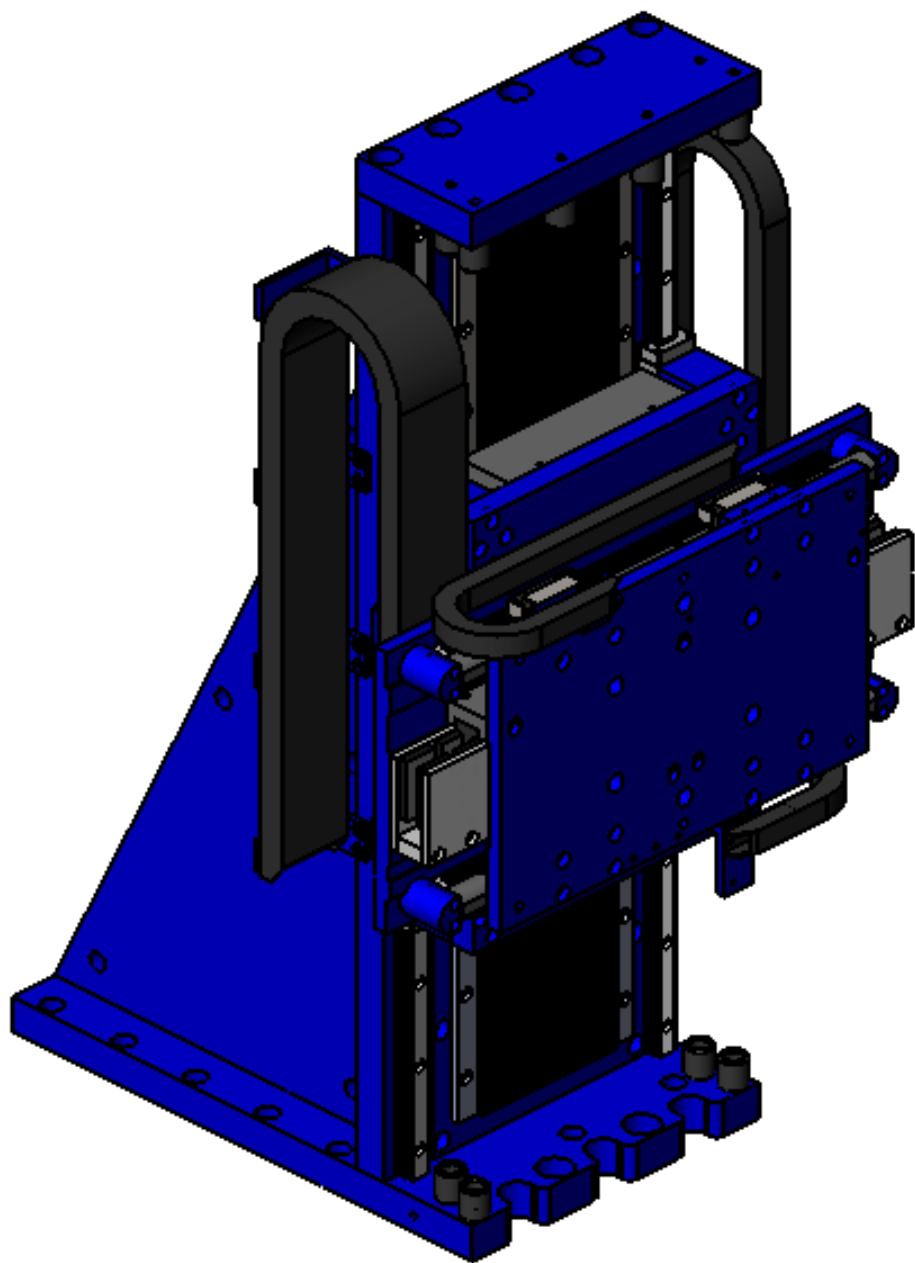
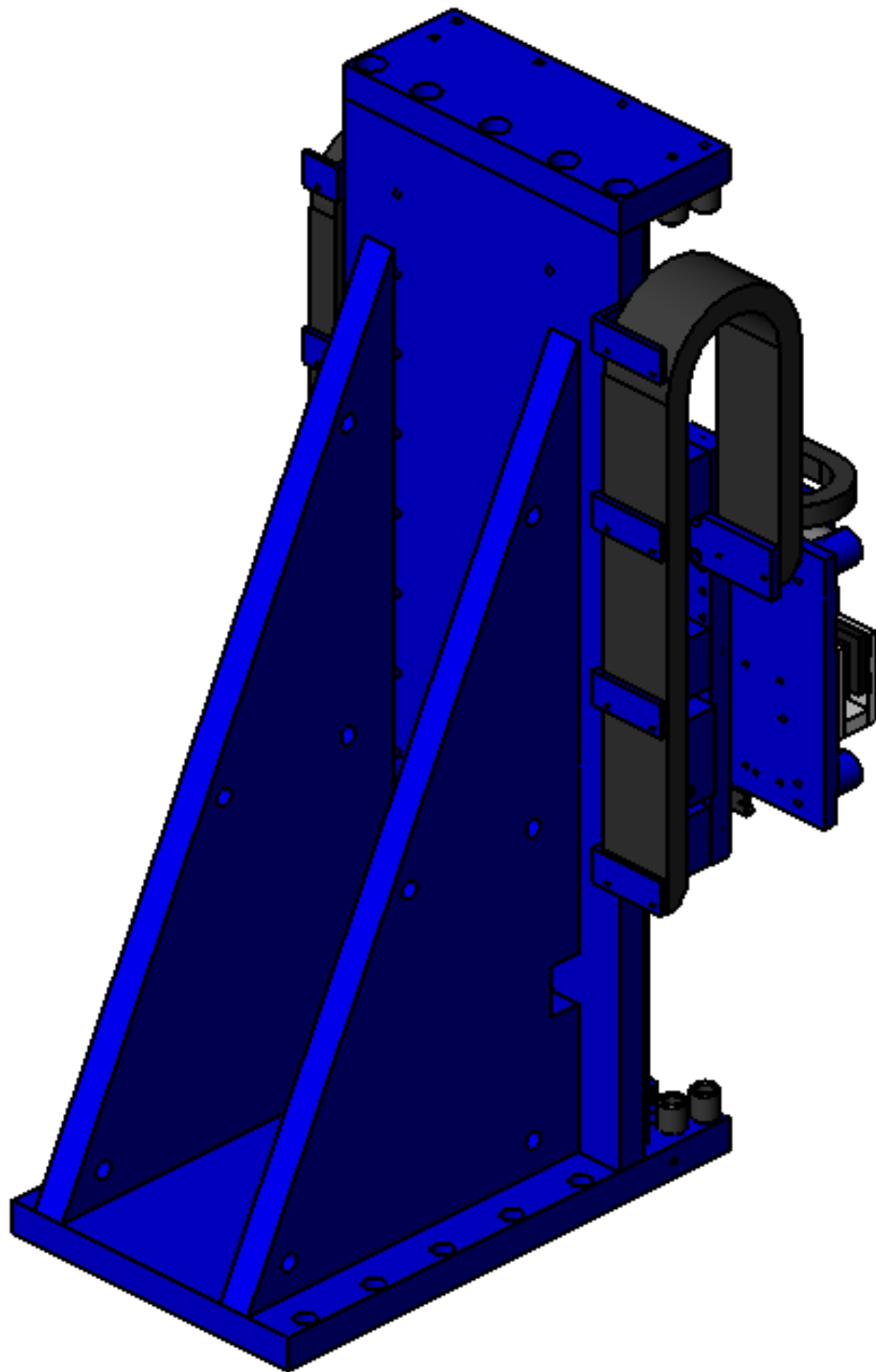

NOTE:
- Moving and Total Mass are per individual stage axis.
- System total mass is 165 Lbs [75Kg](approx.)